

THE ZERA & THE OLEA

Engineered Stone Wall Panels

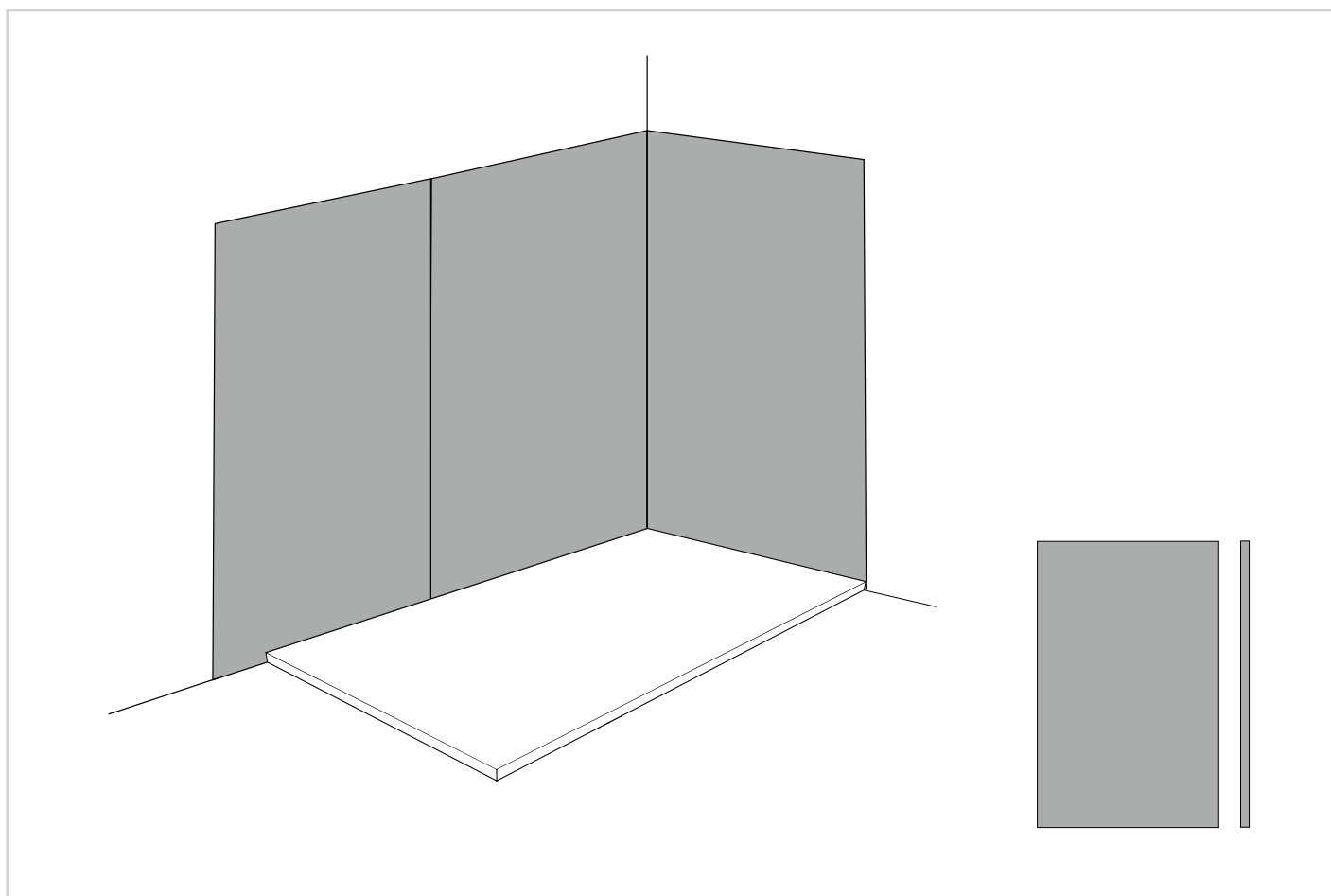

IMPORTANT INFORMATION BEFORE YOU START

Please read carefully and keep this information for further reference.

Thank you for buying a Clearwater Product. To ensure that it works to its full potential, it needs to be fitted correctly. Check the contents of the pack carefully before installation.

Bathroom Brands will not be held responsible for any de-fit/ re-fit costs where faulty product has been fitted. If any fault is found with materials or workmanship, it must be reported immediately to the manufacturer. Remedial action will be taken, based on information received, on condition that:

1. Full details are supplied to the manufacturer.
2. The product has not been modified or tampered with;
3. The manufacturer is informed of any damage/shortages prior to installation.
4. The product has not been installed, or attempts have been made to install.







We do not accept responsibility for any problems that may occur through incorrect installation. This product should only be installed by a suitably qualified plumber/installer.

Should the installation be completed by a non-qualified person any product guarantee maybe considered invalid. For a claim made under our warranty, written certification of your installer's qualifications may be required.

BEFORE YOU START

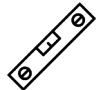
Store the panel horizontally. Check that the panel IS IN PERFECT CONDITION. Do not use the cutter.
The base and walls must be made of mortar and never of sand only. For correct installation, the base must be perfectly LEVELED, SMOOTH AND DRY.
Before installing the panels, the walls and panels should be dry-cleaned to remove dust and dirt, and the back of the panels should be cleaned with industrial alcohol.

Tools Required (not supplied):

Silicone and Adhesive PU (Polyurethane)		Gloves	
Measuring Tape		Spirit Level	
Plaster		Safety Glasses	
Soft Cloth			

INSTALLATION

1



Protect the shower tray. The walls must be concrete or similar material.

2

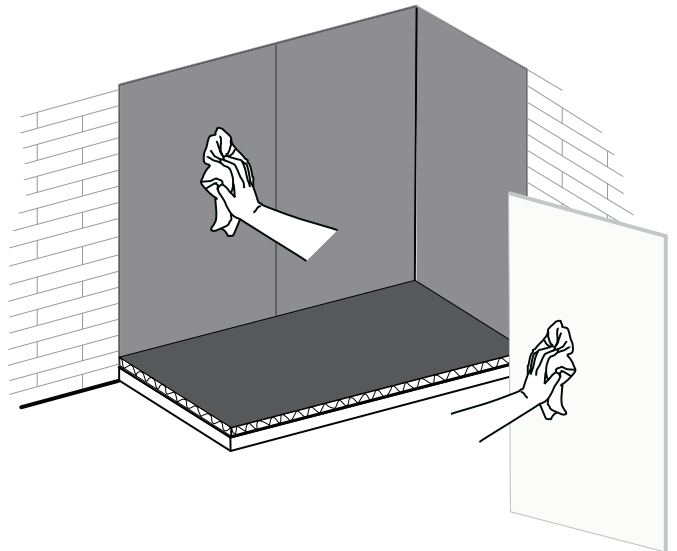

The wall and the panel must be dry and free of dust before gluing them together.

3

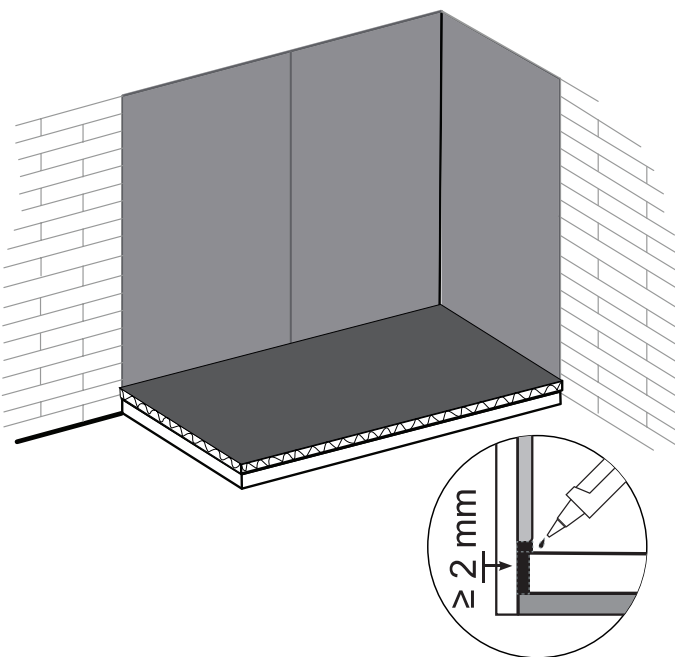

Leave an expansion joint of min. 2 mm between the shower tray and the wall.

4

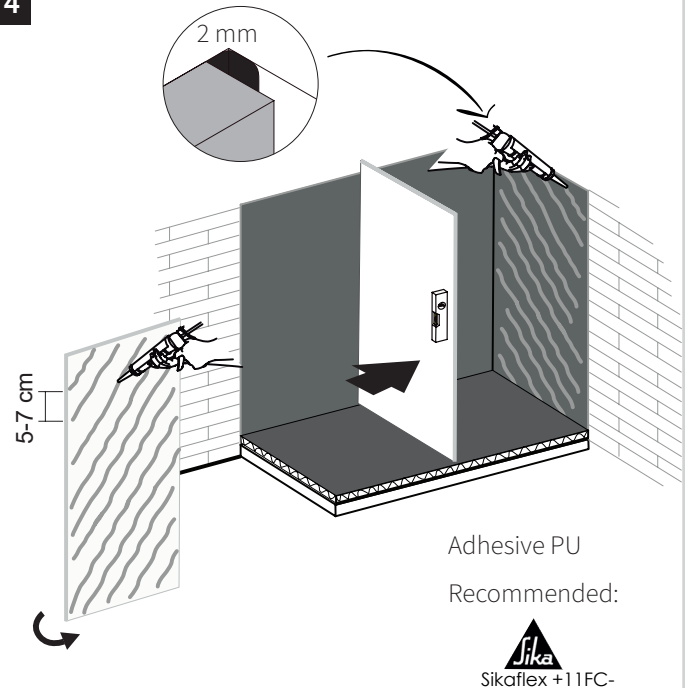

Apply 10 mm thick beads of adhesive PU (Sikaflex-11FC+) all over the wall and the panel.

INSTALLATION

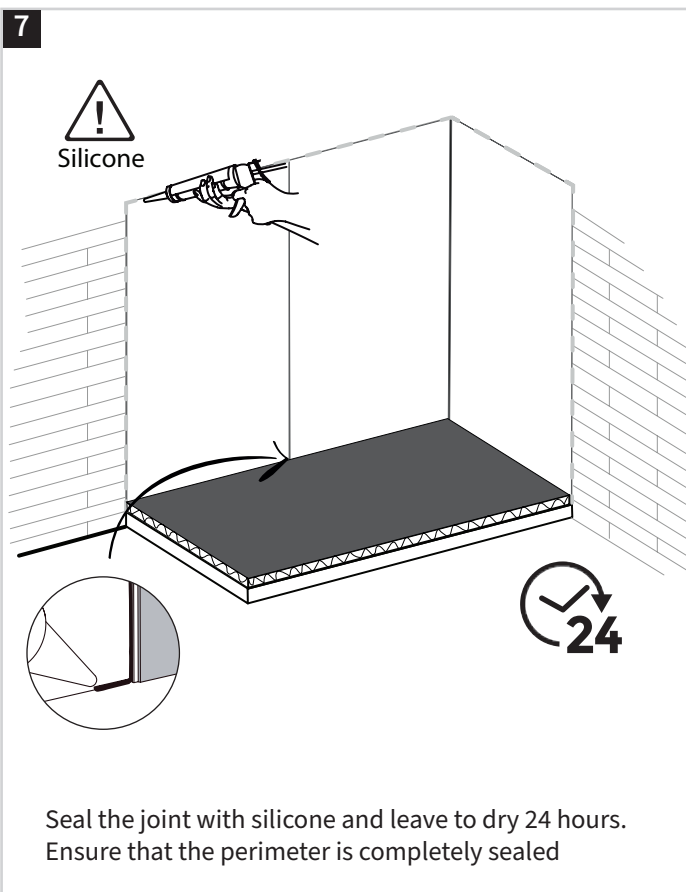
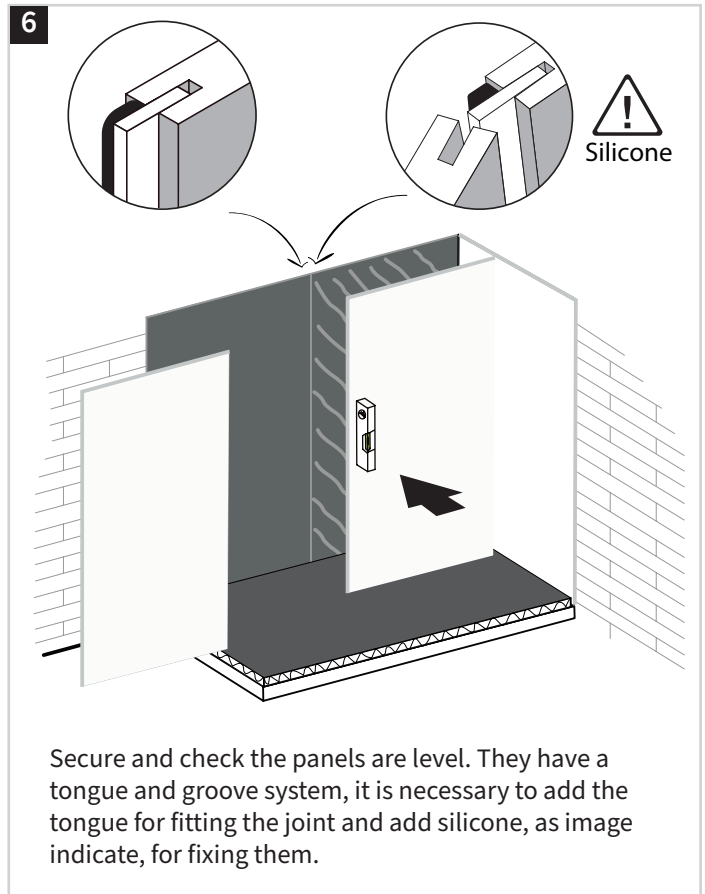
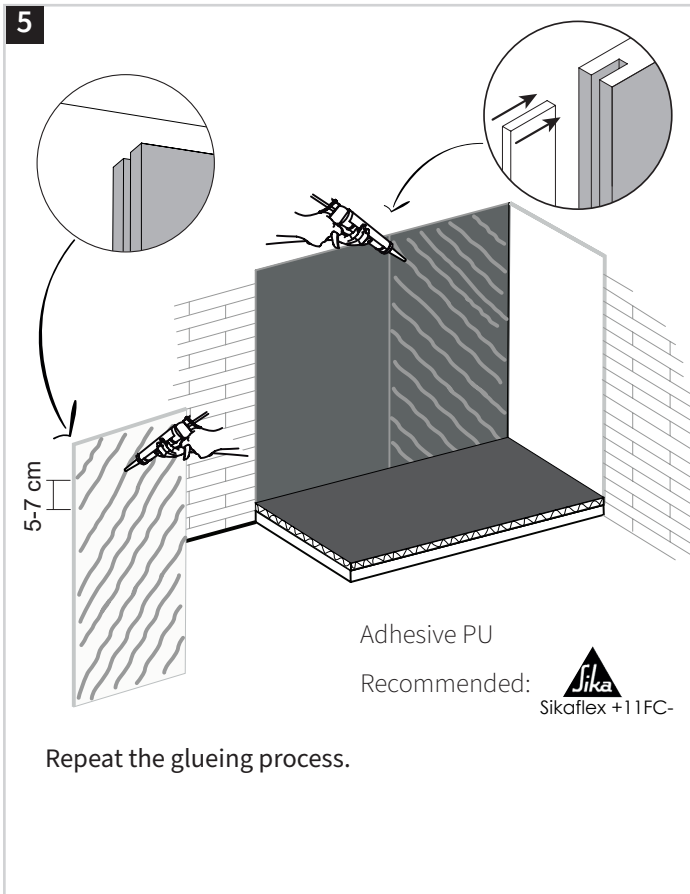

CARE & MAINTENANCE

Pay special attention to the product installation as any cement or mortar residue may damage it. In order to remove them, use a specific cement cleaner, DETERDEK from FILA or similar is recommended. Do not use SOLVENTS, ACIDS or ABRASIVE products. Wear protective gloves, goggles and mask.. Avoid rubbing the surface directly to avoid scratching it.

After every use, clean with water and ensure a good ventilation of the bathroom. For the routine cleaning, use water, liquid cleaners and soft cloths or non-abrasive sponges. Never use scourers or abrasive substances as they can damage the surface. Don't mix different cleaning products.

In order to remove limescale residues, use an antiscala product following this steps:

1. - Apply the antiscala product with the help of a damp cloth over the entire surface.
2. - Leave the product to act for 15 minutes, then rinse thoroughly.

If stains persist, after cleaning with soap and water, use cleaning vinegar diluted in water. In this case, repeat the above steps and let the product act for 5 minutes.

In case of stubborn stains, before applying the appropriate stain remover, clean the surface by rubbing with a plastic brush and rinse with plenty of water.

Pay special attention to the logo so gently clean it as it could be damaged.